



Y85



Y85

The all-new Y85 is a triumph of contemporary design. Her elegant sweeping profile houses an interior sanctuary that resets the benchmark for modern living. Her flybridge is an irresistible invitation to al fresco entertainment with a large dining area opposite a well-equipped wet bar further complemented by a large aft sunpad. With twin MAN V12 engines propelling her to a top speed of 33 knots, she flies past her contemporaries without looking back. An expansive single-level main deck provides ample entertaining space with a flexible galley arrangement. Three separate seating areas ensure the utmost privacy for guests with the crew able to move discretely around the yacht. Below deck, up to eight guests are accommodated across four beautifully appointed en suite cabins. Amidships, the full beam master suite is a champion of spacial design, whilst the en suite VIP cabin, forward, boasts a large double bed and walk-in-wardrobe. Furthermore, one double and one twin cabin (convertible into a double) complete her spacious accommodation. Unmissable, the all-new Y85 is unmistakably Princess.

Le nouveau Y85 est un bijou de design contemporain. Ses élégantes lignes profilées recèlent un havre de l'art de vivre moderne. La grande salle à manger du flybridge, face à un bar tout équipé avec point d'eau, est une invitation irrésistible à recevoir devant le vaste bain de soleil arrière. Propulsé par ses deux moteurs MAN V12, le Y85 file à 33 nœuds, laissant derrière lui ses contemporains. Un pont principal spacieux sur un seul niveau, avec une cuisine à configuration flexible, offre tout l'espace pour recevoir. Trois espaces salons distincts permettent à l'équipage de se déplacer discrètement à bord et assurent aux invités tranquillité et intimité. Au pont inférieur, huit personnes se répartissent sur quatre belles cabines disposant chacune de sa salle de bains particulière. Au milieu du yacht, la suite du propriétaire, sur toute la largeur, est un chef d'œuvre de conception de l'espace. Plus à l'avant, la cabine VIP avec salle de bains attenante jouit d'un grand lit double et d'une penderie-dressing. L'aménagement à l'espace confortable se complète d'une cabine double et d'une cabine à deux lits (convertibles en lit double). Emblématique, le nouveau Y85 a tout d'un Princess.

El totalmente nuevo Y85 es un triunfo del diseño contemporáneo. Su elegante y amplio perfil alberga un santuario interior que restablece el punto de referencia de la vida moderna. Su flybridge es una invitación irresistible al entretenimiento al aire libre, con una amplia zona de comedor frente a un bar con fregadero bien equipado, complementado por un gran solarium de popa. Con dos motores gemelos MAN V12 que lo impulsan a una velocidad máxima de 33 nudos, vuela más allá de sus contemporáneos sin mirar atrás. Una amplia cubierta principal de un solo nivel proporciona un amplio espacio de entretenimiento con una disposición flexible de cocina. Tres áreas separadas para sentarse aseguran la máxima privacidad para los huéspedes, y permiten que la tripulación pueda moverse discretamente alrededor del yate. Bajo cubierta, cuatro hermosos camarotes con baño ofrecen alojamiento hasta a ocho invitados. En medio del barco, el camarote principal ocupa toda la manga y es un campeón del diseño espacial, mientras que el camarote VIP con baño en suite de proa cuenta con una gran cama doble y vestidor. Además, un camarote con cama doble y otro con dos camas individuales (convertible en doble) completan su amplio alojamiento. Imprescindible, el nuevo Y85 es inconfundiblemente Princess.

La nuovissima Y85 è un trionfo del design contemporaneo. Il suo elegante e ampio profilo ospita un santuario degli spazi interni che rimette in discussione ogni riferimento del moderno living. Il suo flybridge è un irresistibile invito a divertirsi al fresco con un'ampia area da pranzo di fronte a un mobile bar completato da un ampio prendisole a poppa. Con doppi motori MAN V12 che la spingono a una velocità massima di 33 nodi, supera di volata le sue contemporanee senza mai voltarsi indietro. Un ponte principale aperto, sviluppato su un unico livello, garantisce un ampio spazio dedicato al divertimento con una disposizione della cucina di bordo flessibile. Tre aree di seduta separate assicurano la massima privacy per gli ospiti lasciando la possibilità all'equipaggio di muoversi discretamente per lo yacht. Sottocoperta, fino a otto ospiti possono essere alloggiati nelle quattro cabine con bagno in suite splendidamente arredate. Al centro della nave la master suite a tutto baglio è un esempio speciale di design di prim'ordine, mentre la cabina VIP in suite, davanti, vanta un ampio letto matrimoniale con cabina armadio. Inoltre una cabina matrimoniale e una doppia (convertibile in matrimoniale) completano la spaziosa sistemazione degli alloggi. Imperdibile, la nuovissima Y85 è inequivocabilmente Princess.

Новейшая модель Y85 сочетает в себе лучшие элементы современного дизайна. Ее элегантный корпус скрывает утонченные интерьеры, в которых Вас ждет исключительный комфорт. Флайбридж этой яхты словно приглашает к отдыху под открытым небом в приятной компании — здесь есть просторная обеденная зона, прекрасно оснащенный бар и лежаки для солнечных ванн в кормовой части. Два двигателя MAN V12 позволяют развивать скорость до 33 узлов. Вместительная одноуровневая главная палуба станет Вашим любимым местом для общения, а в трех выделенных зонах для отдыха гости будут чувствовать особый уют. Четыре великолепно обставленные каюты с собственными ванными комнатами на нижней палубе рассчитаны на восемь гостей. В центре яхты расположена мастер-каюта во всю ширину корпуса, а в носовой части — VIP-каюта с двухспальной кроватью и полноценной гардеробной. Довершают планировку жилых помещений две двухместные каюты, в одной из которых установлены сдвижные кровати. Вне всяких сомнений, новая Y85 — образец безупречного и узнаваемого стиля Princess.

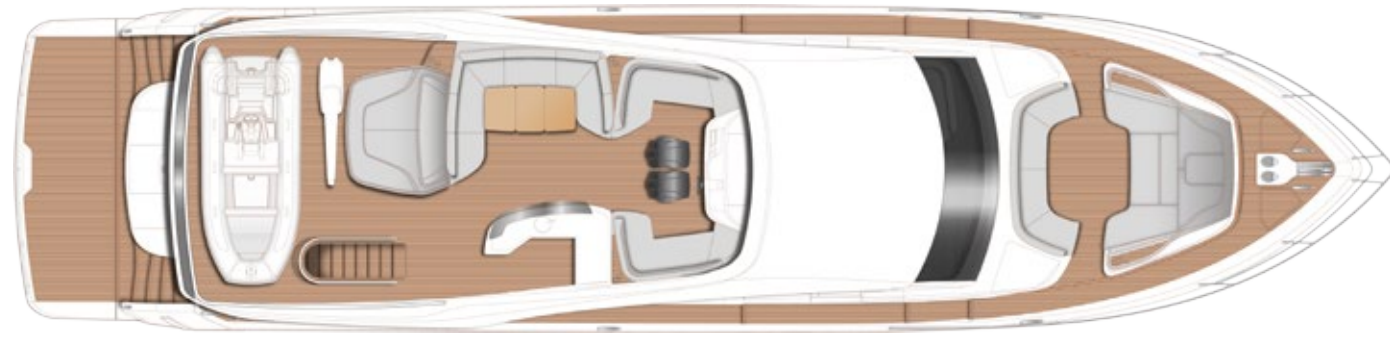

FLYBRIDGE



MAIN DECK

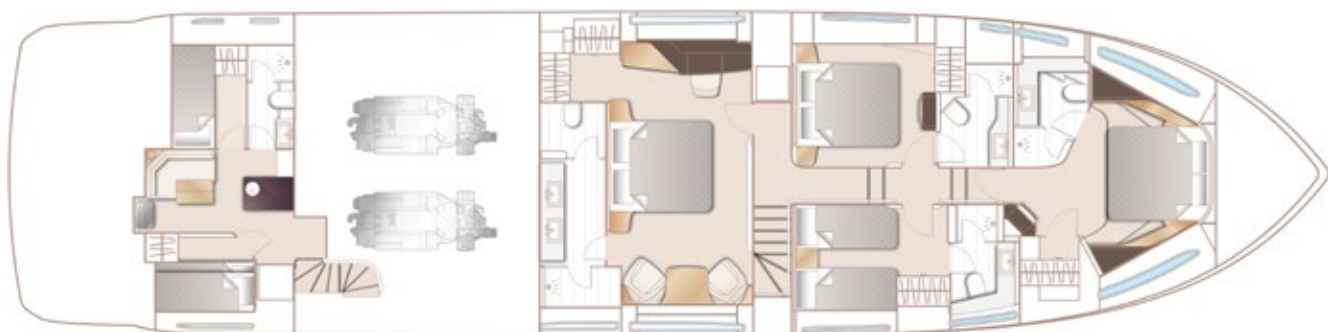

LOWER DECK



OPTIONAL LOWER DECK

PRINCIPAL DIMENSIONS

Length overall (incl. pulpit)	86ft 0in (26.2m)
Length overall (excl. pulpit)	84ft 6in (25.75m)
Beam	20ft 8in (6.3m)
Draft	5ft 9.5in (1.77m)
Displacement approx.	66,500kg (146,607 lbs)*
Fuel capacity	2420 gal/ 2905 US gal/ 11,000l
Water capacity (incl. calorifier)	330 gal/ 396 US Gal/1,500l

ENGINES

MAN V12-1900 (2 x 1900mhp)	Speed range: 31-33 knots*
----------------------------	---------------------------

DECK FITTINGS

- Teak-laid transom platform, cockpit deck, flybridge, flybridge stairway, side decks and foredeck walkthrough
- Twin self-stowing 80kg/176lb and 50kg/110lbs Delta anchors with 100m and 70m of chain respectively
- Twin reversible hydraulic anchor winches with foredeck, main helm and flybridge controls
- Twin electric sternline mooring winches
- Stainless steel cleats, fairleads and handrails
- Foredeck seating and sunbathing area
- Storage lockers for rope, fenders and foredeck sunbed cushions
- Telephone connection point
- Stern docking lights
- LED deck level lighting
- Freshwater deck/anchor wash

COCKPIT

- U-shaped seating with teak folding table
- Twin transom gates leading to bathing platform with electro-hydraulic raise/lower mechanism, foldaway swimming ladder, hot and cold shower
- Door leading to crew quarters and engine room from side deck
- Transom doors giving direct access to lazarette and crew area
- Remote control 4.4m telescopic passerelle with folding handrail
- Cockpit cover

FLYBRIDGE

- Helm position with powered raise/lower console, repeat navigation equipment including radar/chartplotter and engine instrumentation
- Twin adjustable helm seats
- U-shaped seating area with folding teak table
- Twin forward facing L-shaped seating
- Sunpad with storage below (option for built-in spa bath)
- Naim audio system with waterproof speakers (2)
- Wetbar including sink with electric barbecue and drawer refrigerator
- Optional crane (550 kg SWL)
- Life raft storage
- Console and seat covers

WHEELHOUSE

- Twin helm seats with electric adjustment for helmsman
- U-shaped seating with table to port
- Helmsman's door to side deck and electric opening window to port
- Full engine instrumentation including fuel gauges, exhaust temperature, fuel contamination alarms, rudder position indicator
- Navigation system including colour radar, GPS and chartplotter (2 displays), VHF/RT, speed and distance log, echo sounder with alarm, autopilot and high speed magnetic compass
- Controls for bow thruster, windscreen wipers, bilge pump and trim tabs (with indicator)

- Intercom to flybridge
- Automatic foghorn with loudhailer
- Chart storage
- 24v and 240v control panel
- Red night lighting
- Toughened glass screen (clear for night vision)

DECK SALOON

- Twin L-shaped seating area with two-seater sofa and coffee table
- Entertainment centre incorporating 55" UHD LED TV on electric raise/lower mechanism with Naim audio system and ceiling mounted speakers (4)
- Sideboard unit with bottle and glass storage and refrigerator
- Dining area (8 people) with full-height panoramic window
- Day head

GALLEY

- 4-zone induction hob
- Combination microwave/convection oven with grill
- Twin stainless steel sinks with mixer tap
- Full-height refrigerator/deep freeze
- Icemaker
- Dishwasher
- Storage lockers, cupboards and drawers
- Access door to side deck
- Electrically operated sliding screen to fully enclose galley

ACCOMMODATION

- All cabins and bathrooms feature opening portholes and air conditioning outlets
- All cabins feature 220/240v power points
- All mattresses are pocket sprung
- All bathrooms feature full shower stalls, electric freshwater toilets, extractor fan and 240v shaver points

OWNERS STATEROOM

- Large double bed with bedside tables and drawers below
- Dressing area with wardrobes with hanging and drawer storage
- Dressing table with chair
- Occasional table with seats fore and aft
- Built-in safe
- 55" UHD LED TV with Naim audio system with speakers (2) and subwoofer
- En suite bathroom with heated towel rail

FORWARD STATEROOM

- Large double bed with drawers below
- Walk-in wardrobe with shelves
- Dressing table with stool
- 32" HD LED TV
- Naim audio system with CD/DVD paired with ceiling mounted speakers (2)
- En suite bathroom

STARBOARD GUEST CABIN

- Two single beds with drawers below (with the option of powered conversion to double)
- Wardrobe with shelves
- Storage lockers
- Bedside table with storage
- Ensuite bathroom

PORT GUEST CABIN

- Large double bed with drawers below
- Wardrobe with shelves
- Dressing table with stool
- Storage lockers
- Bedside tables with storage
- En suite bathroom

LOWER ACCOMMODATION LOBBY

- The lobby area has a full-height storage cupboard with the option of fitting an additional washer/dryer

CREW QUARTERS

- Captain's cabin with single bed, wardrobe and storage lockers
- Crew cabin with two single beds, wardrobe and storage lockers
- Bathroom with separate stall shower, electric freshwater toilet and washbasin
- Crew mess with microwave oven, sink, refrigerator and washing machine with separate dryer
- Access to engine room

INTERIOR FINISH

- Furniture in Rovere Oak with satin or high gloss finish. Walnut or Alba Oak available as an option
- All guest bathroom worktops and floors in choice of marble, granite or quartz
- Galley worktops in choice of granite or quartz
- Choice of high quality carpet and upholstery fabric from extensive range
- Curtains, blinds or sunscreens to all windows and portholes
- Timber-laid galley and wheelhouse floors

POWER AND DRIVE SYSTEMS

- 5-bladed propellers in nickel aluminium bronze
- Bow thruster (350kg/771lbft)
- Power-assisted electro-hydraulic steering system with hydraulic back-up
- Electronic engine and gear shift control system
- Dripless shaft seals
- Engine room extractor fan with electronic time delay

ELECTRICAL SYSTEM

- 24 Volt:
 - 2 x heavy duty batteries for engine starting
 - 6 x heavy duty auxiliary batteries
 - 2 x 60 amp battery charger charges both banks of batteries via an automatic switch charging system
- Remote battery master switches with control switch at main panel
- LED lighting throughout

220/240 Volt:

- 27kW generator in own sound shield with water cooled specially silenced exhaust
- 2 x 63 amp shore support inlet
- Earth leakage safety trip, polarity check system, circuit breaker on all circuits
- Power points in all areas

FUEL SYSTEM

- Twin fuel tanks (in NS8 marine grade alloy) with interconnection system giving 2420 gal/2907 US gal/11000l
- Fuel fillers on port and starboard side decks
- High capacity duplex fuel filters/water traps with audible and visual fuel contamination warning system
- Remote fuel cocks in cockpit locker

WATER SYSTEM

- 285 gal/342 US gal/1295l plus 45 gal/54 US gal/205l hot water calorifier, heated by engines and 240v immersion heater
- Water level gauge
- Electric freshwater WC system with 132 gal/158 US Gal/600l holding tank

AIR CONDITIONING

- 204,000Btu chilled water system with outlets in all accommodation areas and incorporating reverse cycle heating with linked windscreen de-mist system. Suitable for tropical conditions (40°C)

FIRE EXTINGUISHERS

- Automatic/manual override fire extinguishers in engine room with warning system at both helm positions and incorporating engine air vent closure system
- Hand-operated fire extinguishers in all cabins, galley, crew and lower helm

BILGE PUMPS

- Automatic electric bilge pumps
- High capacity manual bilge pumps with valve system and suction points in same areas

OTHER ITEMS SUPPLIED AS STANDARD

- Set of cutlery, crockery and glasses (8)
- Set of towels (8 large, 8 small)
- Ensign staff
- Fenders (8) and warps (4)
- First aid kit
- Set of manuals

