

V40

V40

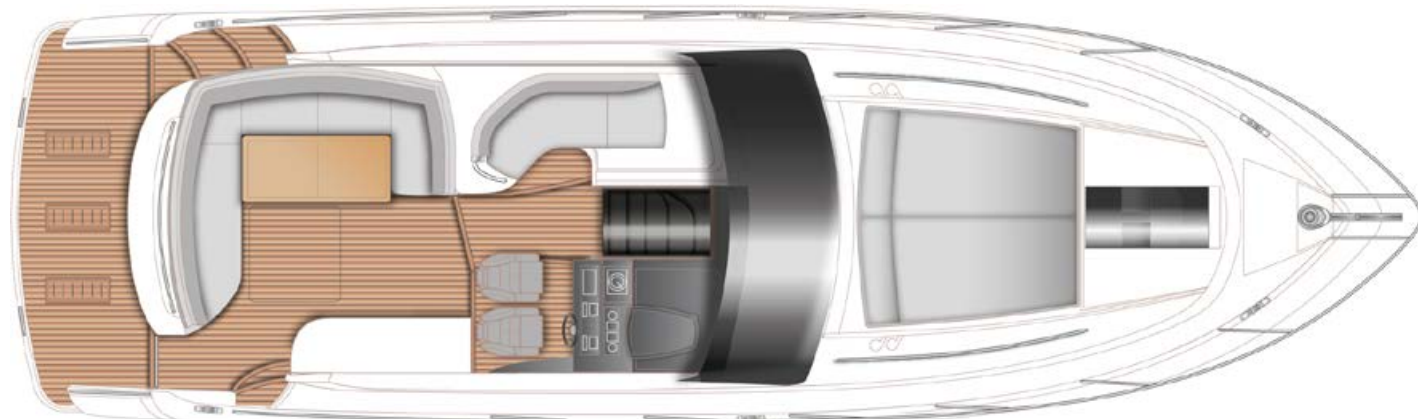

MAIN DECK

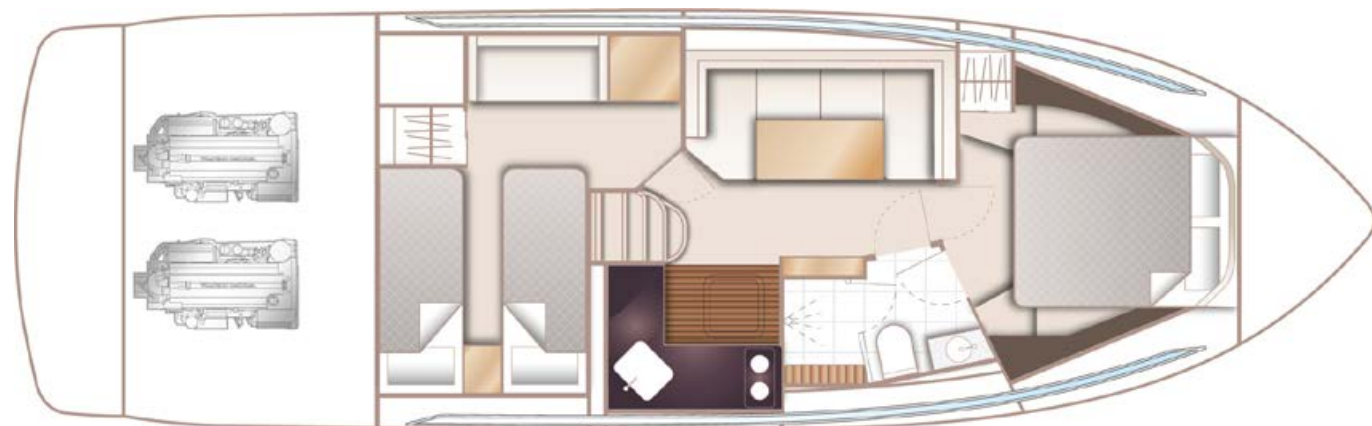

LOWER DECK



The new V40 quintessentially showcases the dynamic exterior, exceptional seakeeping and voluminous space of our V Class. Her port light windows cascade across the length of her deep-V hull, flooding the saloon and cabins with light. When entertaining, her spacious cockpit enjoys a beautiful teak table and well-equipped wetbar in a striking oyster grey with an option to specify a convertible sunbed aft.

Below deck, her pewter grey and off-white colour palette depict the modern V Class look throughout. Her spacious saloon and well equipped galley combine for a highly sociable entertaining space, while both cabins exude contemporary style and generous proportions. The forward cabin has an en-suite bathroom with secondary access to the saloon whilst the aft cabin can be fitted with optional sliding berths to provide easy conversion to a double when required.

V40

PRINCIPAL DIMENSIONS

Length overall (incl. pulpit)	42ft 6in (12.98m)
Length overall (excl. pulpit)	41ft 6in (12.65m)
Beam	12ft 5in (3.81m)
Draft: (Drives raised)	1ft 10in (0.56m)
Draft: (Drives lowered)	3ft 4in (1.02m)
Displacement approx.	9,100kg (20,062 lbs)*
Fuel capacity	160 gal/192 US gal/730l
Water capacity (incl. calorifier)	71 gal/85 US gal/322l

DECK FITTINGS

- Teak-laid transom platform, cockpit deck and stairs to side decks
- Reversible electric anchor winch with helm position controls
- Self-stowing 16kg/35lbs Delta anchor with 30m of chain
- Chain locker with stowage for 4 fenders (stowage for an additional 2 fenders in engine room)
- Stainless steel cleats, fairleads and handrails
- Remote control searchlight

COCKPIT

- U-shaped seating with teak table (with optional conversion to double sunbed)
- L-shaped seat
- Electrically operated sliding sun roof
- Wetbar including sink, top loading cool box and optional electric barbecue
- Lockable gas strut assisted hatch to engine room
- Transom gate leading to bathing platform (with optional electro-hydraulic raise/lower mechanism), foldaway swimming ladder and hot and cold shower and space for tender
- Lifteraft storage locker
- Large transom storage locker with access via transom doors and hatch in stern seat
- Locker housing 220/240v shore support inlet
- Locker with remote fuel cocks
- Cockpit Aft tonneau cover
- Optional sunpad layout available with aft seat extension and sliding backrests for conversion

HELM POSITION

- Twin helm seat with bolster
- Full engine instrumentation including fuel gauges and engine controls
- Navigation system including VHF/RT, speed and distance log, echo sounder with alarm and high speed magnetic compass
- Controls for windscreen wipers, bilge pump, anchor winch, trim tabs and sterndrive trim
- Chart table
- Remote control searchlight

SALOON

- U-shaped sofa with dining table (converts to double berth)
- Sideboard unit with glass and bottle storage
- Stereo radio/DVD/MP3 with saloon and cockpit speakers
- 24v and 220/240v electrical control panels
- Storage cupboards and lockers

GALLEY

- 2-zone gas hob with flame failure device
- Remote solenoid switch for gas system
- Combination microwave/conventional oven with grill
- Stainless steel sink with mixer tap
- Refrigerator with freezer compartment
- Waste bin
- Storage cupboards and drawers

ACCOMMODATION & INTERIOR FINISHES

- All cabins and bathroom feature opening portholes
- All cabins feature 220/240v power points
- All mattresses pocket sprung
- Furniture in Rovere Oak with satin or high gloss finish. American Walnut or Alba Oak available as an option
- Avonite worktops and tiled floors in all guest bathrooms
- Avonite worktop and timber-laid floor in galley
- Choice of high quality carpet and upholstery fabric from extensive range
- Curtains, blinds or sunscreens to all windows and porthole

OWNER'S CABIN

- Large double bed with drawers below
- Wardrobe with shelves
- Vanity unit
- Storage lockers and drawers
- Deck hatch with integrated skylight and blind
- Overhead and individual berth lights
- En suite bathroom with day access incorporating electric freshwater toilet, separate stall shower, 240v shaver point, storage lockers and mirror

ENGINE OPTIONS – DIESEL

Twin Volvo D6-330 DP (2 x 330mhp)	Speed range: 36-38 knots†
-----------------------------------	---------------------------

AFT GUEST CABIN

- Two single beds with storage below (with option of sliding conversion to double)
- Sofa (with option of conversion to berth)
- Wardrobe with shelves
- Storage lockers and drawers
- Overhead and individual berth lights

POWER AND DRIVE SYSTEMS

- Twin duo-prop stern drives
- Power-assisted electro-hydraulic steering system with hydraulic back-up
- Electronic engine and gear shift controls
- Trim tabs with indicators
- Engine room extractor fan

ELECTRICAL SYSTEMS

24 Volt:

- 2 x heavy-duty batteries for engine starting
- 2 x heavy-duty auxiliary batteries
- Battery link facility with remote control at helm position
- 35 amp 12v float battery charger charging both banks of batteries via automatic switch charging system
- LED lighting throughout

220/240 Volt:

- Shore support inlet in cockpit locker with storage for cable
- Polarity check system
- Earth leakage safety trip
- Power points to all areas

FUEL SYSTEM

- Twin fuel tanks (in NS8 marine grade alloy) with interconnection system giving 160 gal/192 US gal/730l capacity
- Fuel fillers on port and starboard side decks
- High-capacity fuel filters / water traps
- Deck filler

WATER SYSTEM

- 64 gal/77 US gal/290l plus 7 gal/8.5 US gal/32l hot water calorifier and heated by engine and 240v immersion heater
- Water level gauge
- Deck filler

FIRE EXTINGUISHERS

- Automatic/manual override fire extinguisher in engine room with warning system at helm position
- Hand-operated fire extinguishers (4) in owner's cabin, guest cabin, galley and cockpit

BILGE PUMPS

- Automatic electric bilge pumps (6)
- High-capacity manual bilge pump with valve system and suction points in same areas

OTHER ITEMS SUPPLIED AS STANDARD

- Ensign staff
- Fenders (6) and warps (4)
- First Aid kit
- Tool kit
- Set of manuals
- Quilted bedspreads in all cabins

* Displacements are calculated with 50% fuel and water but with no optional equipment fitted or other gear or crew aboard. † Speed estimates are given in good faith but without warranty or liability on the part of Princess Yachts International. Specifications may be changed at any time without notice or liability. Please consult the USA Specification Brochure for details regarding the North American specifications for this models.

PRINCESS YACHTS INTERNATIONAL

Newport Street, Plymouth, Devon, PL1 3QG, UK Tel: +44 (0) 1752 203 888

www.princessyachts.com info@princessyachts.com